

COMMERCIAL PRV Piston Type Pressure Regulating Valve

DESCRIPTION

The COMMERCIAL PRV Series Pressure Reducing and Regulating Valve automatically reduces a high inlet pressure to a lower delivery pressure and maintains the lower pressure within acceptable limits.

The valve is designed for water, air, light oil, gases (except steam) and other fluids not corrosive to brass. It is ideally suited for large commercial and industrial water or air service installations.

The COMMERCIAL PRV Series has no diaphragm — the regulating device is a spring opposed balanced piston. These regulators are exceptionally simple in construction and have very few internal parts. The balanced piston allows extreme fluctuations in inlet pressures to act uniformly on the piston, producing more sensitive operation while providing for closer regulation and quiet performance.

The COMMERCIAL PRV Regulator has an adjustment range of 100 - 875kPa depending on the adjusting spring installed. Refer to the Spring Range Table for various spring options.

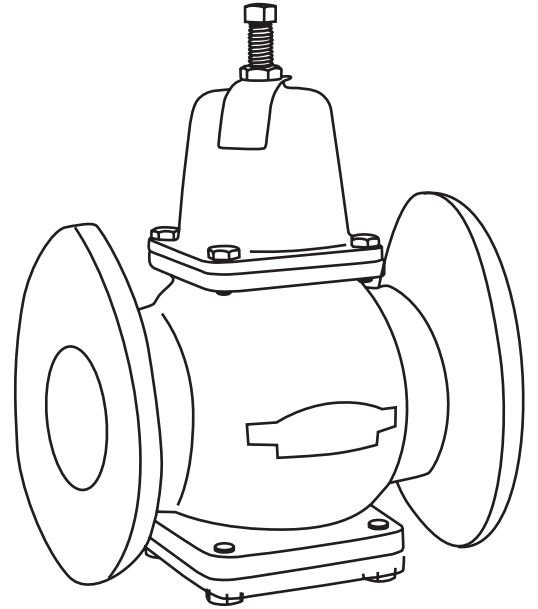

FEATURES AND BENEFITS

Large commercial and industrial water or air service installations:
Exceptional high capacity for all services.

Balanced piston design:
Provides for closer regulation and quiet performance.

Every valve is tested for performance prior to shipping:
Specify and install with confidence!

SPECIFICATION

A pressure reducing valve shall be installed to deliver air or water at a controlled pressure. The valve shall be high capacity with a bronze body. The valve shall be a spring opposed, balanced piston type with a stainless steel seat ring. The valve shall be a COMMERCIAL PRV Pressure Regulating Valve.

TYPICAL INSTALLATION

The COMMERCIAL pressure regulators should be installed in the horizontal position with the spring chamber upright. For other installation requirements consult the supplier.

For ease of operation and maintenance, it is suggested that the manual shut-off valves be installed upstream and downstream from the valve.

COMMERCIAL PRV Piston Type Pressure Regulating Valve

SPECIFICATION DATA

Performance:

Outlet pressure range 100 - 500kPa, 350 - 750kPa (standard), 550 - 875kPa
 *Maximum temperature 80°C
 Maximum initial pressure 2000 kPa
 Service air, water, light oils and gases (except steam)

Materials:

Body Bronze
 Spring Chamber Bronze
 Piston Brass
 Seat Ring Stainless steel
 Seat Disc Buna-N
 Adjusting Spring Steel
 Wiper Felt Felt
 O-Rings Buna-N
 Bottom Cap Bronze

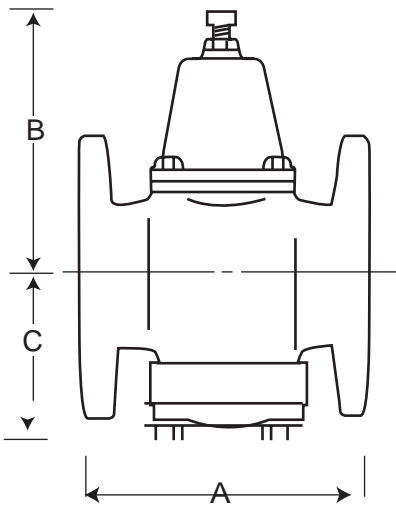
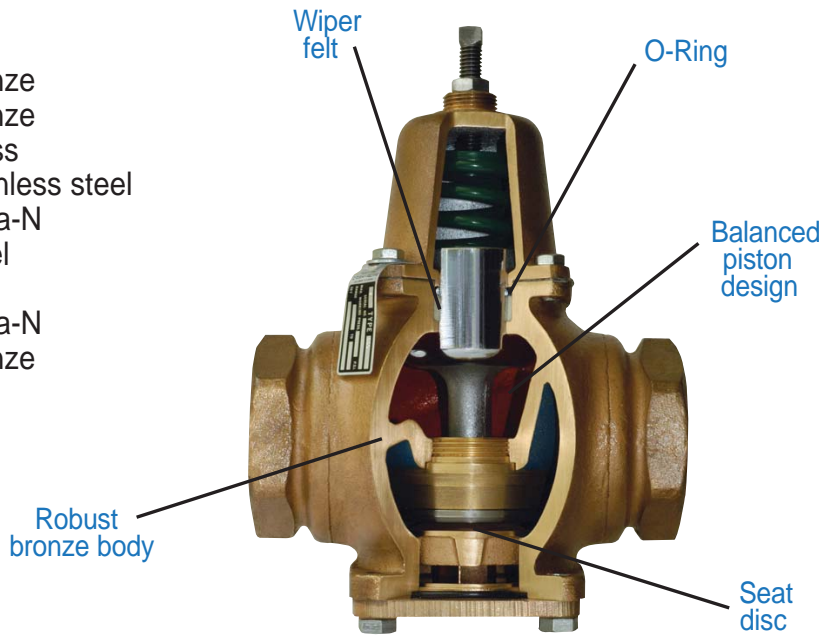

DN	A	B	C
50mm Flanged C	198mm	180mm	90mm
65mm Flanged C	201mm	180mm	90mm
80mm Flanged C	210mm	180mm	95mm
100mm Flanged C	222mm	180mm	95mm

PERFORMANCE SPECIFICATIONS

DN	Differential Pressure (kPa)			
	70	175	350	550
50mm Flanged C	340 LPM	456 LPM	610 LPM	720 LPM
65mm Flanged C	435 LPM	570 LPM	912 LPM	1100 LPM
80mm Flanged C	532 LPM	684 LPM	1065 LPM	1330 LPM
100mm Flanged C	532 LPM	684 LPM	1065 LPM	1330 LPM

