



CALEFFI

Reduced Pressure Zone

Backflow Preventers

Prevent the return of contaminated water to the water supply system

The Caleffi Bonus

- The latest European technology
- More compact design
- Designed for maximum flow
- Ease of testing
- Inline serviceability
- Not restricted by side-entry test ports
- Non-splash tundish optional
- Sizes 15mm to 50mm come with male union ends

Series

574-575



Australian
Standard

AS/NZS 2845 Lic 1764



Caleffi #574 RPZ Backflow Preventers

- Threaded union connections sizes 15, 20, 25, 32, 40 and 50mm
- Maximum water temperature: 65°C
- Pressure test points: upstream, intermediate, downstream zones
- Recommended media: potable water
- Approved to Australian standard AS/NZ 2845 Lic 1764

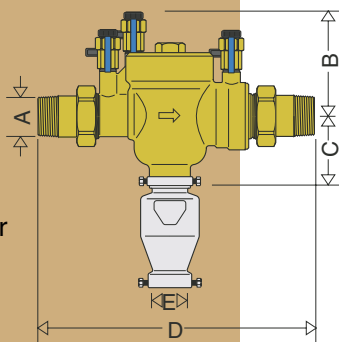

Code	A	B	C	D	E	Weight
574040	15	103	44.5	227	40	2.9
574050	20	103	44.5	227	40	2.9
574600	25	100	72.5	280	40	3.6
574700	32	100	72.5	280	40	3.8
574800	40	130	103.4	387	50	11.3
574900	50	130	103.4	395	50	11.4

Caleffi #575 RPZ Backflow Preventers

- Flanged connections: DN 65, DN 80 and DN 100; PN 10
- Maximum water temperature: 65°C
- Pressure test points: upstream, intermediate, downstream zones
- Recommended media: potable water
- Approved to Australian standard AS/NZ 2845 Lic. 1764

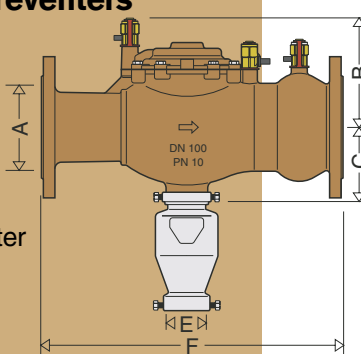

Code	A	B	C	D	E	Weight
575006	65	132.5	108.5	305	50	17.0
575008	80	170	115	470	80	26.5
575010	100	170	115	470	80	28.0

In the 15mm through 32mm sizes of #574's, the body, cover and all components in contact with water are made of Dezincification Resistant brass alloy or plastic.

In the 40mm and 50mm sizes, the body and cover are made of bronze. The sliding rods of the check valves, the relief valve seat and the springs are made of stainless steel.

All the rubber parts are suitable for use with potable water.

Flow Curves

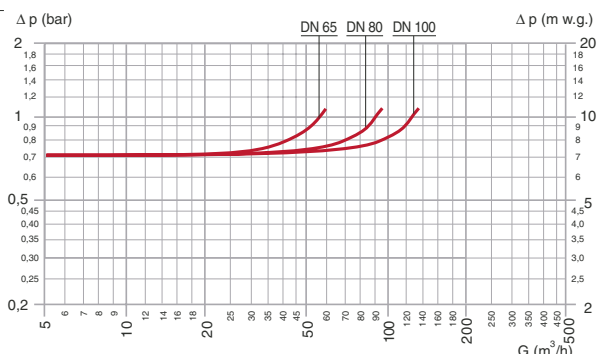
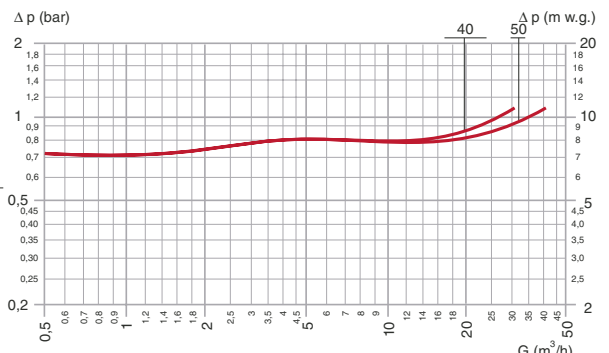
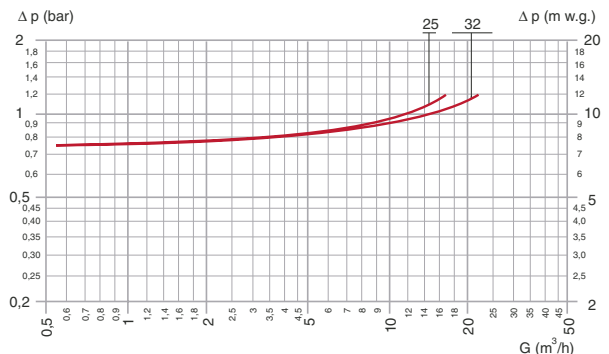
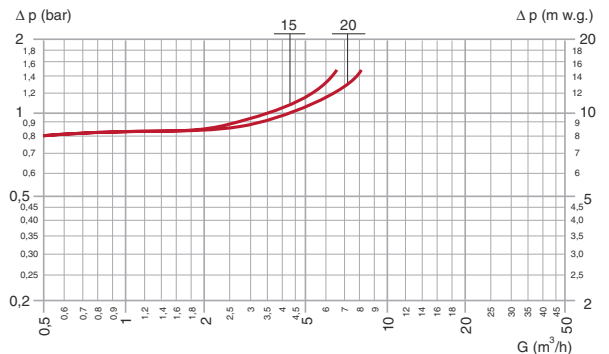

In the 65mm, 80mm and 100mm sizes of #575's, the body, cover and internal components are made of bronze.

The shafts, sliding rods of the check valves, the relief valve seat and the springs are made of stainless steel. All the rubber parts have been approved as suitable for use with potable water.